



# PureLiving™ Companion

## Anti-Wandering System Wireless Door Alarm

### Product Overview

The PureLiving™ line for loved one's safety and security drastically improves on current anti-wandering systems.

Our PureLiving™ Anti-Wandering System will ensure your loved one's safety and dignity and your peace of mind. It ensures that a loved one with Alzheimer's disease or dementia who may be prone to wander, will be safe and secure in your home or facility.

The PureRFid™ Companion is an ideal complement to your existing plan-of-care program. Easy to install with step by step instructions, it enables you to again be in control of your schedule and time.

Installation entails simply installing the PureRFid™ Reader above the door and plugging it into an outlet. A discreet wrist tag is worn by the loved one, allowing freedom to be active in approved areas. Once the bracelet comes within a set proximity to the doorway, the local alarm sounds until the person with the tag moves from the area. You can easily set the distance for the warning to allow you sufficient time to secure your loved one before they can exit the area.

The companion is meant to complement your loved one's total care program and should not be thought of as your only, or last line of defense in preventing wandering.

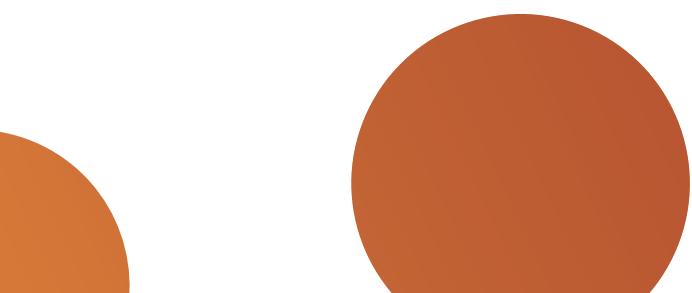

## The Companion Anti-Wandering System: It's easy to install, scalable and affordable

### Main Features

- Stand-alone or Integrated with Pure Monitor system for Institutional use
- Optional external wireless alarm
- Blends into any décor
- Plugs into 110-240 V wall outlet
- Self-setting range detection
- Push button calibration
- Waterproof wrist tag
- Can monitor any door with a localized alarm
- Localized 85dB alarm
- Optional external buzzer alarm 110dB
- Wireless technology with simple step by step installation instructions
- Optional employee / master tag to disable alarms
- 1 year warrantee on door alarm and wrist tag

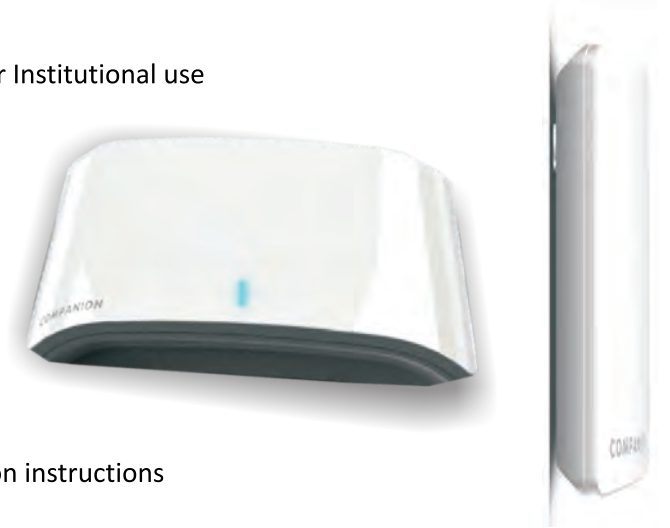

| Ordering Information |  | Specifications         |                          |   |
|----------------------|--|------------------------|--------------------------|---|
| Part Number          | Description  | Specification          | Door Alarm Kit           | Wrist Tag                               |
| <b>PRF-CPN-KIT</b>   | Companion Door Alarm Kit - Includes door alarm and wrist tag | <b>Power</b>           | 120-240 V Wall Outlet    | Internal Battery                        |
| <b>PRF-CPN</b>       | Companion Door Alarm Kit - Includes door alarm only          | <b>Size - LxWxD</b>    | 3.2" x 6"x1.25"          | 1.4"x1.4"x0.44" (Does not include Band) |
| <b>PRF-WT</b>        | Companion Wrist Tag  | <b>Range</b>           | Adjustable - up to 10 ft | Not Applicable                          |
|                      |  | <b>Alarm Output</b>    | Sounder @ 85 dB          | Not Applicable                          |
|                      |  | <b>Enclosure</b>       | Indoor                   | Waterproof                              |
|                      |  | <b>Shipping Weight</b> | <b>Reader</b><br>4lbs    | <b>Reader Kit</b><br>5lbs               |
|                      |  |                        |                          | <b>Wrist Tag Only</b><br>1lbs           |



Tel: +972-9-889-0880 Fax: +972-9-889-0814  
1, Arie Shenkar st., Herzliya, 4672501 Israel

[www.SuperCom.com](http://www.SuperCom.com)